

TITLE: PROPOSED GROUND (PARKING) PLUS FOUR STORED RESIDENTIAL BUILDING AT MOUZA: DABGRAM, PARGANA: BAKANTHAPUR, DIST: JALPAIGURI, WEST BENGAL.

OWNER: GOURISUT PROJECTS PVT. LTD. REPRESENTED BY DIRECTOR: SRI. PRADIP KUMAR AGARWAL S/O. SRI. MAHABIR PRASAD AGARWAL.

LOCATION: SARBAPALLY, BY LANE ESTERN BYPASS, P.O.: SALUGARA, SILIGURI- 734008

SCHEDULE OF LAND :-
 MOUZA: DABGRAM, PARGANA: BAKANTHAPUR, DIST: JALPAIGURI, WEST BENGAL.
 PLOT NO. 184/419 (RS), 511 (LR) KHATAN NO. - 631 (RS), 1220 (LR) TOUZ NO. - 31 (RS), SHEET NO. - 5 (RS), 4 (LR) J.L. NO. 02, WARD NO. - 42 (S.M.C.) P.S. - BHAKTINAGAR DIST. JALPAIGURI, WEST BENGAL. HOLDING NO. - VL/100/C/2.

SCHEDULE OF DOORS & WINDOWS

NO.	SILL	LINTEL	SIZE
D	2150	1500	1500X2150
D1	2150	1200	1200X2150
D2	2150	900	900X2150
D3	2150	750	750X2150
DW	2150	2400	2400X2150
DW1	2150	1800	1800X2150
DW2	2150	1550	1550X2150
DW3	2150	1350	1350X2150
DW4	2150	1300	1300X2150
DW5	2150	900	900X2150
W1	350	2150	1500X1800
W2	350	2150	1200X1800
W3	350	2150	850X1800
W4	1050	2150	900X1100
W4A	1050	2150	750X1100
W4B	1050	2150	1550X1100
W5	1250	2150	600X900
ST	350	2150	1200X1200
V	1250	2150	600X900

AREA STATEMENT :-
 LAND AREA = 1357.78 SQ.M

SL. NO.	ITEMS	PERMISSIBLE	PROPOSED
01	GR. COVERAGE	50.00%	48.96%
02	COVERED AREA	678.89 sq.m	678.45 sq.m
03	1ST. FLOOR	678.89 sq.m	678.45 sq.m
04	2ND. FLOOR	678.89 sq.m	678.45 sq.m
05	3RD. FLOOR	678.89 sq.m	678.45 sq.m
06	4TH. FLOOR	678.89 sq.m	678.45 sq.m
07	TOTAL FL. AREA	2715.56 sq.m	2715.56 sq.m
08	F.A.R.	2.0	1.80
09	LEFT OPEN SPACE	679.33 sq.m	
10	HT. OF THE BUILDING	20.0 M	14.85 M
11	COMMON AREA WITH STAIR, CASE AND LIFT	16.18 sq.m	(EACH FLOOR)
12	REQUIRED PARKING	22 NOS.	PROVIDED 24 NOS. OPEN PARKING PROVIDED BY NOS. OPEN PARKING
13	NO. OF TENEMENT	36 NOS.	
14	AREA OF EACH TENEMENT	1ST. - 4TH. FL. 181.12 SQ.M (18.12 M x 10.00 M) 1ST. - 4TH. FL. 181.12 SQ.M (18.12 M x 10.00 M) 1ST. - 4TH. FL. 181.12 SQ.M (18.12 M x 10.00 M) 1ST. - 4TH. FL. 181.12 SQ.M (18.12 M x 10.00 M)	
15	TOTAL COVERED AREA (WITHOUT COMMON AREA)	FOR TENEMENT - 612.27 SQ.M (244.98 SQ.M)	
16	SITE PLAN NO. 403 DATED 5-9-18		
17	LUGG. HEAD NO. 1185/02/2018 DATED 8-11-17		

CERTIFICATE OF STRUCTURAL STABILITY :-
 I have do hereby certify that the foundation and superstructure of the building proposed by the applicant on plot no. 184/419 (RS) situated at MOUZA: DABGRAM, PARGANA: BAKANTHAPUR, DIST: JALPAIGURI, WEST BENGAL, is safe and sound and will stand firm and true under all normal conditions of service and settlement of soil and other conditions. I am not responsible for any alteration of the building in accordance with the Code of practice and national Building Code.

RAJEN KOLEY
 Civil Engineer, Class II
 SMC Registration No. 1185/02/2018
 Jalpaiguri, West Bengal

CERTIFICATE OF BUILDING PLAN :-
 I have do hereby certify that the foundation and superstructure of the building proposed by the applicant on plot no. 184/419 (RS) situated at MOUZA: DABGRAM, PARGANA: BAKANTHAPUR, DIST: JALPAIGURI, WEST BENGAL, is safe and sound and will stand firm and true under all normal conditions of service and settlement of soil and other conditions. I am not responsible for any alteration of the building in accordance with the Code of practice and national Building Code.

RAJEN KOLEY
 Civil Engineer, Class II
 SMC Registration No. 1185/02/2018
 Jalpaiguri, West Bengal

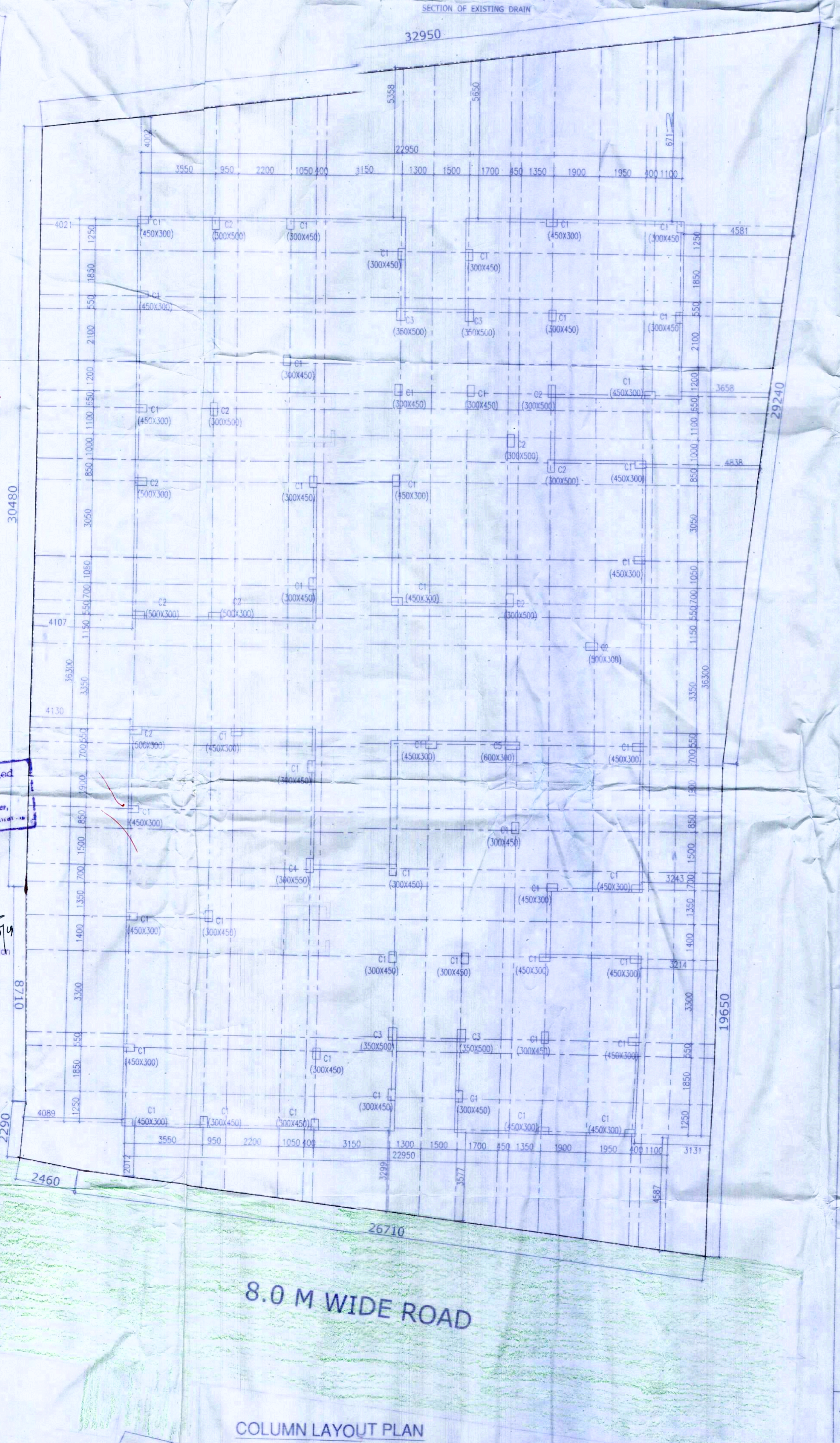
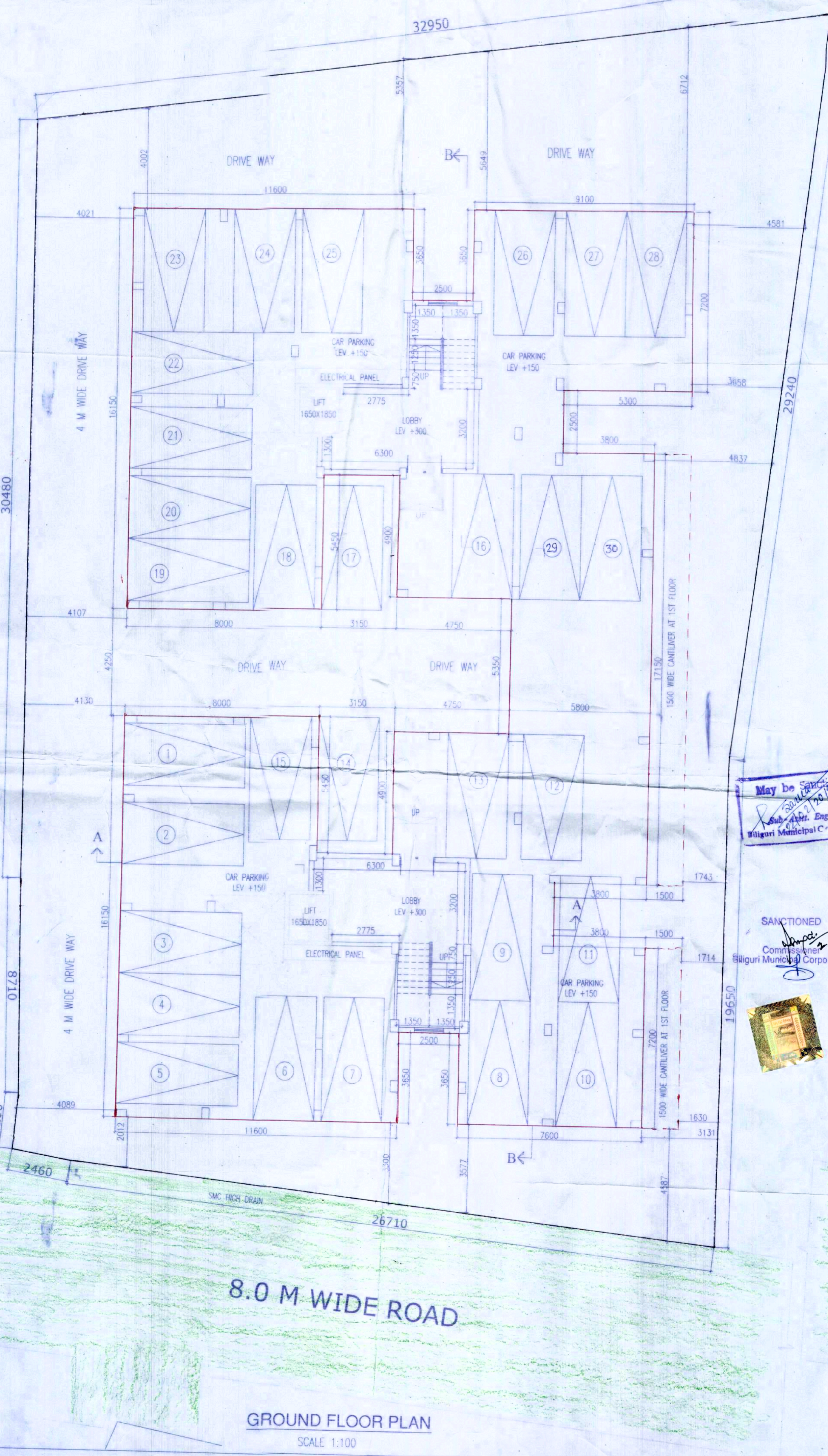

NOTES :-

1. ALL DIMENSIONS IN METERS.
2. ALL WALLS ARE 200 MM THICK AND SHALL BE CONSTRUCTED WITH AAC BLOCK.
3. ALL DOORS AND WINDOWS SHALL BE CONSTRUCTED WITH 150 MM THICK R.C.C. SLAB.
4. ALL FLOORS SHALL BE CONSTRUCTED WITH 150 MM THICK R.C.C. SLAB.
5. ALL ROOFS SHALL BE CONSTRUCTED WITH 150 MM THICK R.C.C. SLAB.
6. ALL ROOFS SHALL BE CONSTRUCTED WITH 150 MM THICK R.C.C. SLAB.
7. ALL ROOFS SHALL BE CONSTRUCTED WITH 150 MM THICK R.C.C. SLAB.
8. ALL ROOFS SHALL BE CONSTRUCTED WITH 150 MM THICK R.C.C. SLAB.
9. ALL ROOFS SHALL BE CONSTRUCTED WITH 150 MM THICK R.C.C. SLAB.
10. ALL ROOFS SHALL BE CONSTRUCTED WITH 150 MM THICK R.C.C. SLAB.
11. ALL ROOFS SHALL BE CONSTRUCTED WITH 150 MM THICK R.C.C. SLAB.

SHEET NO. 1/2 ARCHITECTS: HOWRAH / KOLKATA / SILIGURI

SCALE	DATE	DEALT	CHECKED
1:100	27.08.19	UMA	SKG